

# light jacket®

Attachable Light for Electrosurgical Pencil

## INSTRUCTIONS FOR USE



**Rx ONLY**

**STERILE**

### OPERATING CONDITIONS

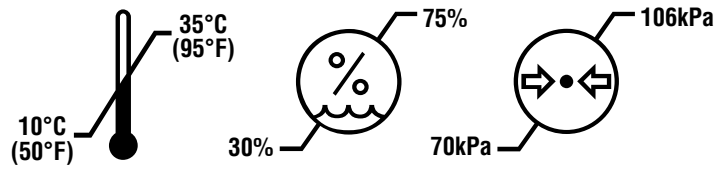

### STORAGE CONDITIONS

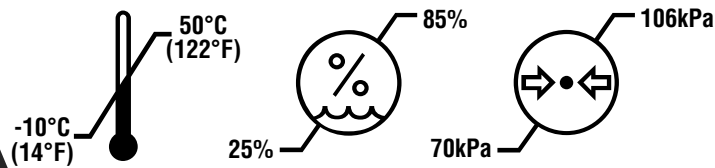

Pathy Medical, LLC  
1000 Bridgeport Ave. Ste. 400  
Shelton, CT 06484  
Tel: +1-203-816-8000 • [www.pathymedical.com](http://www.pathymedical.com)



## LIGHT JACKET® DESCRIPTION

The Light Jacket® Attachable Light for Electrosurgical Pencil is offered as a sterile, one-time use disposable medical device for providing enhanced illumination of the surgical site when attached to an electrosurgical pencil.

## INTENDED USE

The device is a self-powered light source attachment to electrosurgical pencils and is intended to provide visible illumination of the surgical field.

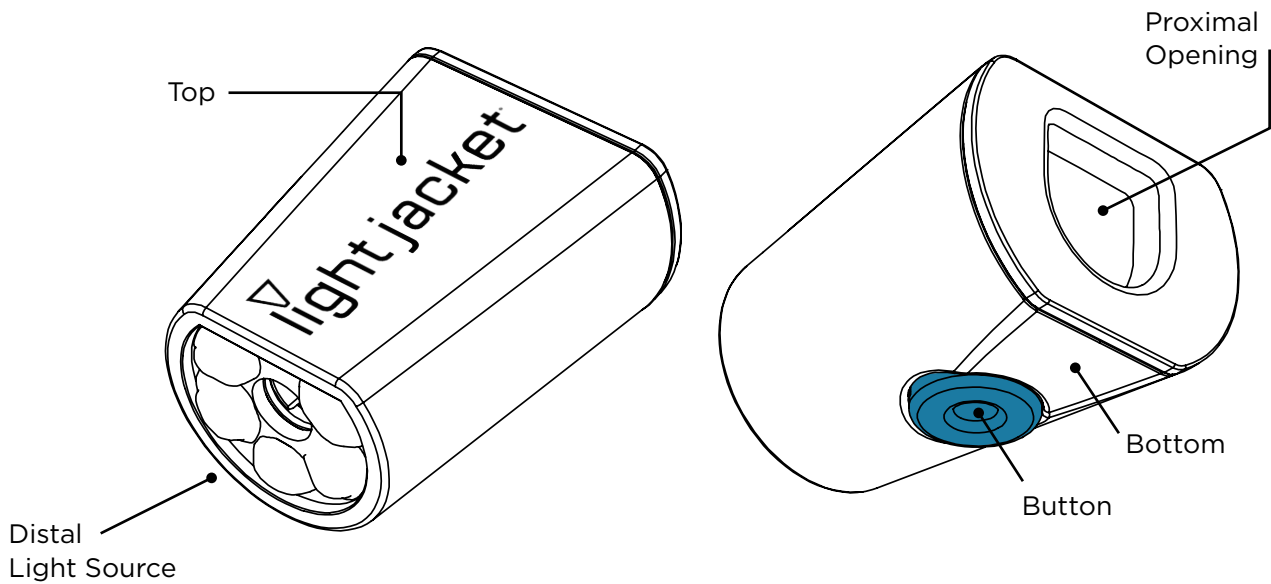

SYMBOL GUIDE							
Do Not Re-Sterilize		Caution		Sterile	<b>STERILE</b>	Catalog Number	<b>REF</b>
Do Not Use If Package Is Damaged		Humidity Limitation		Batch Code	<b>LOT</b>	Legal Manufacturer	
Do Not Re-Use		Temperature Limitation		Expiration Date		Authorized Representative in the European Community	<b>EC REP</b>
Do Not Recharge		Atmospheric Pressure Limitation		Date of Manufacture		Prescription Use Only. US Federal Law restricts this device to sale by or on the order of a physician	<b>Rx ONLY</b>
WEEE Directive Dispose per Local Regulations		eIFU Indicator		Quantity	<b>QTY</b>		

## LIGHT JACKET® DIRECTIONS FOR USE

1. Using aseptic technique, open sterile package and transfer Light Jacket® onto sterile field.

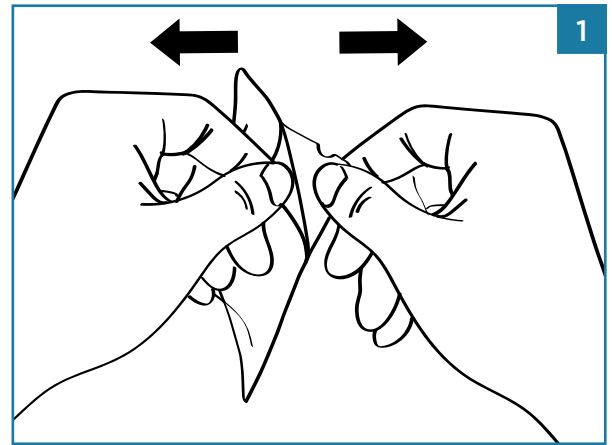

2. Hold the Light Jacket® so light source is positioned distally. Align Buttons/Rocker Switch of electro-surgical pencil with the Light Jacket® logo (top).

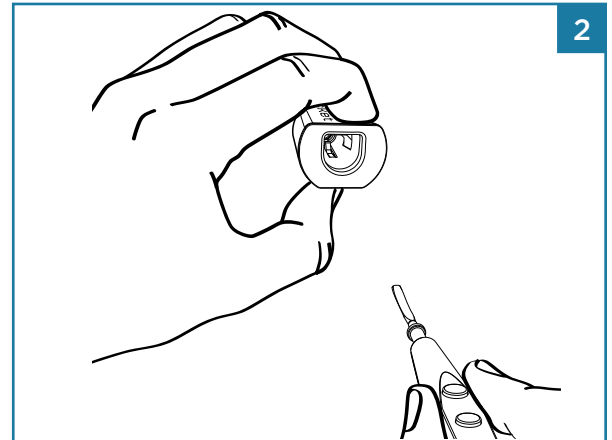

3. With thumb on button (bottom), squeeze until button is fully depressed. Insert electro-surgical pencil into proximal opening of the Light Jacket® until it stops. The Light Jacket® will illuminate.

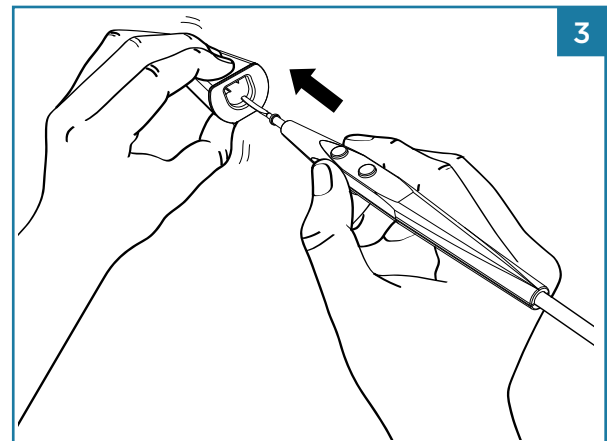

4. Release button to secure the Light Jacket® onto electro-surgical pencil. The Light Jacket® will remain illuminated for 2 hours of use.

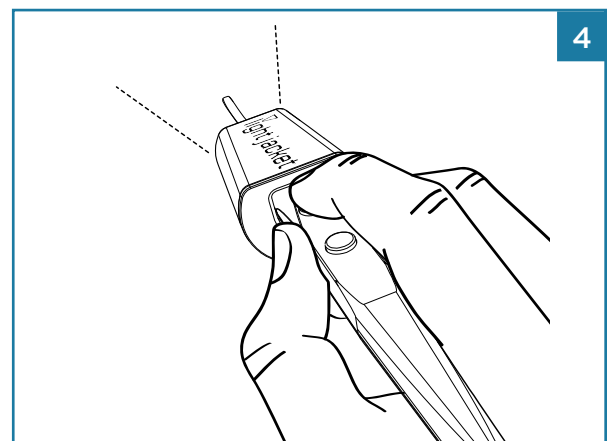

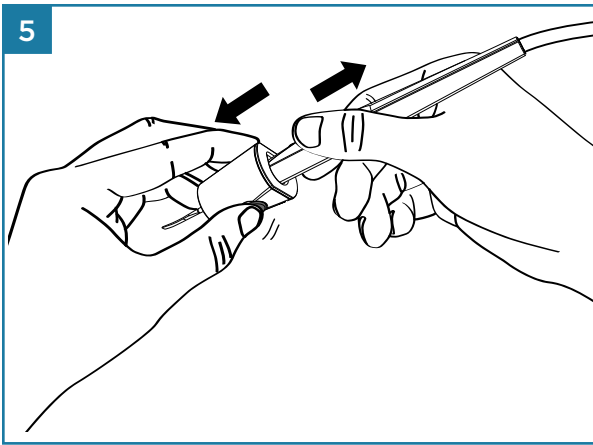

5. To remove the Light Jacket® from electrocautery pencil, squeeze button with thumb until fully depressed. Remove electrocautery pencil. Light will deactivate.
6. When the battery is low, the Light Jacket® will flash and remain illuminated for 30 seconds. If continued illumination is required, replace the Light Jacket® immediately.
7. Dispose of used Light Jacket® in proper manner and in accordance with local laws.

## WARNINGS

- Do not shine Light Jacket® into eyes. May cause temporary blindness.
- Do not install or remove Light Jacket® while over an open surgical cavity.
- Do not leave Light Jacket® in a patient cavity.
- Do not insert finger(s) into Light Jacket®.
- Fire / Explosion / Burn Hazard. Do not crush, disassemble, incinerate, or heat batteries above 100°C/212°F.
- The Light Jacket® contains non-rechargeable batteries. Do not recharge batteries. Dispose of batteries in accordance with local laws.
- Use with untested electrocautery pencils may result in improper attachment, improper light activation/deactivation, and/or damage to the device or pencil.

## RECOMMENDATIONS

- Users should add Light Jacket® to the surgical count.
- Light Jacket® should be attached and removed no more than ten times.
- Light Jacket® should be used to enhance lighting and not as only source of light.
- Light Jacket® is tested for compatibility with the following electrocautery pencils:

Covidien™* Edge™*/Valleylab™* Button Switch Pencil	Covidien™* Edge™*/Valleylab™* Rocker Switch Pencil
Megadyne™* Button Switch Pencil	Megadyne™* Rocker Switch Pencil
ConMed®* GoldLine®* Push Button Pencil	ConMed®* GoldLine®* Rocker Switch Pencil
Medline®* Vega Series Cautery Pencil, Push-Button	Medline®* Vega Series Cautery Pencil, Rocker

Light Jacket, Pathy Medical and their associated logos are trademarks of Pathy Medical, LLC.  
 \*All other trademarks are the property of their respective owners.

